

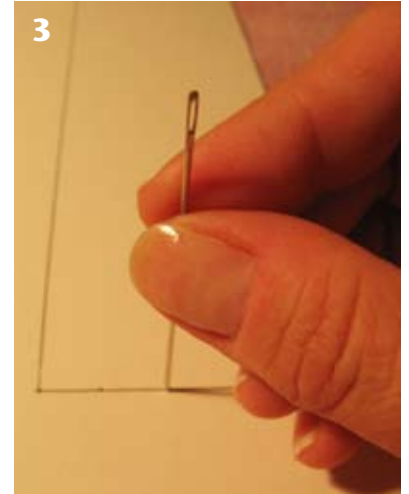

# How to frame fiber art

These directions were produced by **Susan Brubaker Knapp**. They are free, and may be copied and distributed. E-MAIL: [susan@bluemoonriver.com](mailto:susan@bluemoonriver.com)

■ WEB SITE: [www.bluemoonriver.com](http://www.bluemoonriver.com) ■ BLOG: [www.bluemoonriver.blogspot.com](http://www.bluemoonriver.blogspot.com)

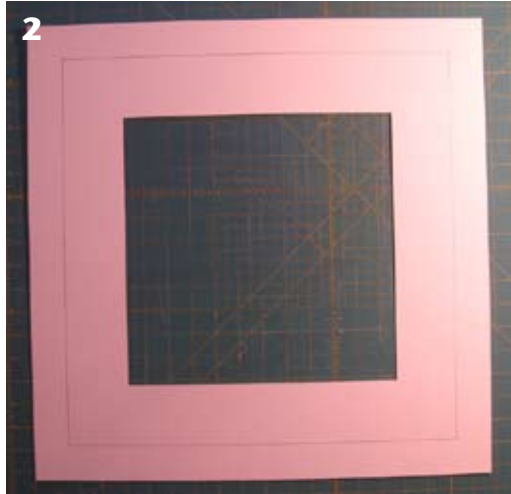

A nice way to finish your piece is to frame it. If you choose this method, make sure you sign the back of your work so that it will still bear your name even if it is taken from the frame later.

Textile pieces should not be framed directly under glass, because any moisture that collects inside the frame can be pressed into the fabric, causing water marks or mildew. Either choose a shadow box, or add spacers between the glass and the mat. To protect your work, make sure to use an acid-free mat.

I found an inexpensive shadowbox frame at Ikea (see **1**). Measure your quilt, and then open the frame and measure your mat. Subtract the size of your quilt from the size of the mat. (Example: Your quilt is 17" square, and the mat is 20 inches square, so  $20-17=3$ . Divide this number by 2 (Example  $3\div 2=1\frac{1}{2}$ .) Add  $\frac{1}{8}$ " to this measurement (Example  $1\frac{1}{2} + \frac{1}{8} = 1\text{-}5/8$ .)

The front of the mat should have a beveled edge. Turn it over onto the back, and draw a line that is this far in from the outer edge, around all the sides (see **2**). Place the mat on an old, clean towel. Use a very fine needle or nail to punch holes along this line every  $\frac{1}{2}$ " or so (see **3**).

Thread a smaller needle with heavy thread, such as hand quilting thread. Place the quilt on the top of the mat and align it with the holes. Take a stitch on the back of the quilt so that your knot is on the back, and bring the needle out at the corner. Go down through the corner hole (see **4**) and come up through the next hole (see **5**).

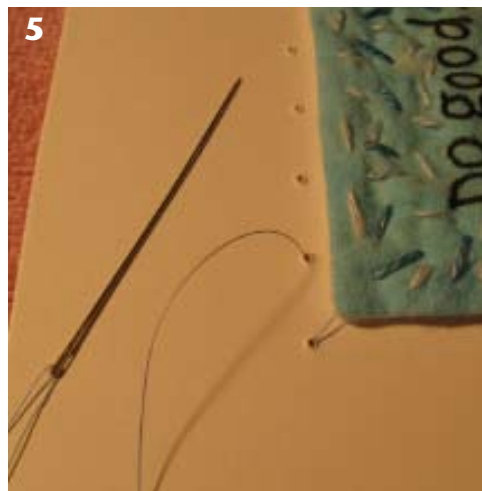
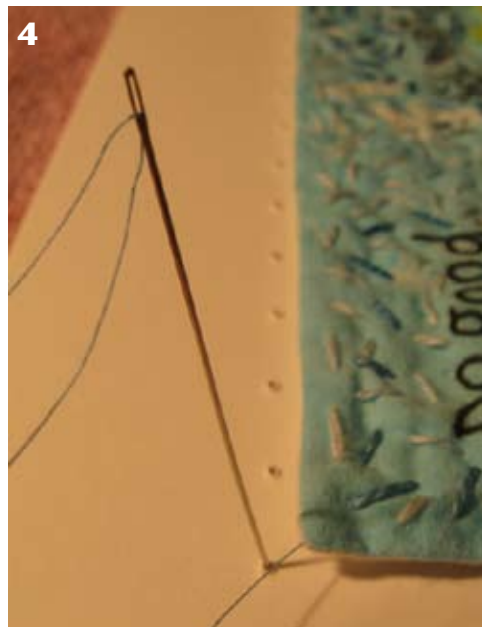



Take a small stitch through the back of the quilt (see **6**). Try to get all the layers except the front (because you don't want your stitches to show on the front). Go back down through the same hole (see **7**), and then on to the next one.

Continue in this manner, pulling the thread taut every few stitches, until you have gone all the way around. If your thread runs out, make a large knot on the back of the mat. Secure your stitches with acid-free artists' tape (see **8**).

Remember to sign your name on the mat with a Micron Pigma pen (see **9**). Clean the glass, insert the mat with the quilt stitched to it, and finish framing according to the frame's directions (see **10**).